

The Accident Database of the CSRTG

IASFPWG May 2011 – CSRTG Accident Database



- **Purpose**
- **Content**
- **Recent Changes**
- **Planned Future Changes**

IASFPWG May 2011 – CSRTG Accident Database



Purpose

Purpose

The primary purpose of the database is to provide a tool to assist in carrying out:

- **Cost Benefit and Risk Analyses**
- **Studies aimed at identifying safety issues**



Database Content

Database Content

Data

- Fields populated primarily by data published by the Authorities
- For accidents where it is not possible to obtain official reports collaboration with the Aviation Safety Network to incorporate their data

Database Content

- Passenger and Cargo operations on aircraft type certificated with 20 seats or more
- Current Version of the Database contains:
 - 3,926 Accidents - period 1967 to 2009
 - 3,208 with textual fields
 - 583 with synopsis of accident reports

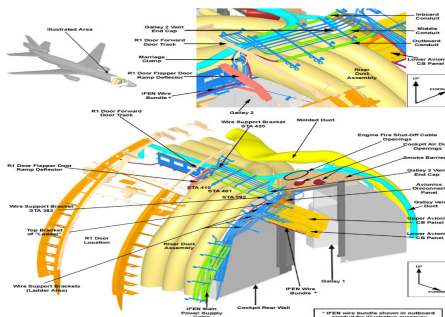

Database Content

- Word Search on Text
- Field Searches
- Web Based



<http://www.rgwcherry-adb.co.uk>

Database Content

Photographs



IASFPWG May 2011 – CSRTG Accident Database



Database Content

Exit Usage

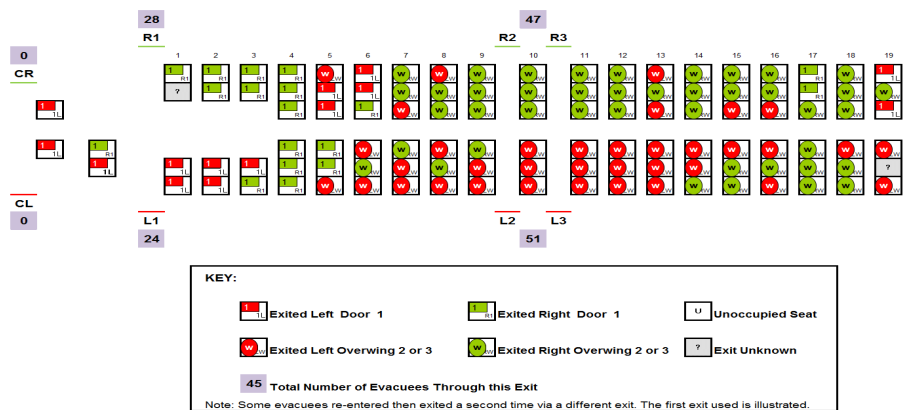

IASFPWG May 2011 – CSRTG Accident Database



Database Content

Injury Location

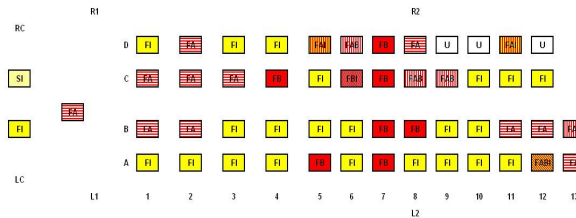

Note: This data includes information determined by the Safety Board, that some passengers switched seats from those assigned, and that the nonrevenue passenger most likely occupied seat 12B

KEY:

FI	FATAL IMPACT	FB	FATAL BURN	SI	SERIOUS IMPACT
FAI	FATAL ASPHYXIOXITY IMPACT INJ	FAB	FATAL ASPHYXIOXITY BURN		
FBI	FATAL BURN IMPACT INJ	U	UNOCCUPIED		
FABI	FATAL ASPHYXIOXITY BURN IMPACT	FA	FATAL ASPHYXIOXITY		

Recent Changes

Recent Changes:

- **New User Guide now available on RGW Cherry & Associates Web-site**

CSRTG Aircraft Accident Database

USER GUIDE

ISSUE 3



Recent Changes to the Database:

**Software
Changes
went live
April 2nd
2012**

CSRTG Aircraft Accident Database

SEARCH DATABASE
MY CUSTOM LISTS
DESIGNATED ACCIDENTS
MY SAVED SEARCHES
DATABASE STATS
INTRODUCTION
ABOUT / CONTACT
GLOSSARY
DISCLAIMER
CHANGE PASSWORD
LOGOUT

Export
Print (3926) Accidents Export (3926) Accidents

REFERENCE contains ?
YEAR RANGE between and
LOCATION contains

Simple Search Advanced Search
Search Above Reset / Show All Advanced Search

Page 1 of 197 Records 1 to 20 of 3926 Page Size: 20
[Clear Tagged Accidents](#) [Add Tagged to Designated](#)
[Tag Selected Accidents](#) [Add Tagged to Custom Lists](#)

REFERENCE	AIRCRAFT TYPE	REGISTRATION	DATE	LOCATION
20091222A	B737-823	N977AN	22-DEC-2009	NORMAN
20091220A	HS748	5Y-YKM	20-DEC-2009	TONJAI
20091207A	EMB135LR	ZS-SJW	07-DEC-2009	GEORGETOWN
20091202A	F100	PK-MJD	02-DEC-2009	KUPANG
20091128A	MD11-F	Z-BAV	28-NOV-2009	SHANGHAI
20091119A	MD82	9Q-CAB	19-NOV-2009	GOMAL
20091118B	B777-200	N209UA	18-NOV-2009	(NEAR) I
20091118A	F100	EP-CFO	18-NOV-2009	ISFAHAM

Primary Changes:

- **ACCIDENT TAGGING** - registered user can tag accidents of interest whilst browsing database. These are highlighted and can be sorted to top (available for registered users). Tagged accidents are saved.
- **DESIGNATED ACCIDENTS** - registered user can create and save personal list of accidents of particular interest.
- **NEW DATA FIELDS** - 'Seat Category' and 'Type Certificated Seat Category' - these will be populated progressively.

Primary Changes:

- **OFFICIAL ACCIDENT REPORTS** - facility added to store these within ADB for user download.
- **ADVANCED SEARCH** - can now search for accidents having PICTURES, INJURY LOCATION DIAGRAMS, EXIT USAGE DIAGRAMS, EXIT AND ASSIST MEANS TABLES, OCCUPANT DATA TABLES or OFFICIAL ACCIDENT REPORTS.

Primary Changes:

- **SEARCH IN CUSTOM LIST** - can now carry out simple and advanced search within a custom list.
- **PICTURE VIEWER** - now provides zoom-in/out.
- **SESSION TIME OUT** - increased to approx 8 hours. (Note: time out may be less if user has dynamic IP Address)
- **TEXT SEARCH** - performance of 'text string' search improved.

Planned Future Changes

Planned Future Changes:

- **Addition of NTSB Accident Reports - downloadable**
- **Addition of 2010 & 2011 Accident Data**
- **Transition to the FAA Website**